

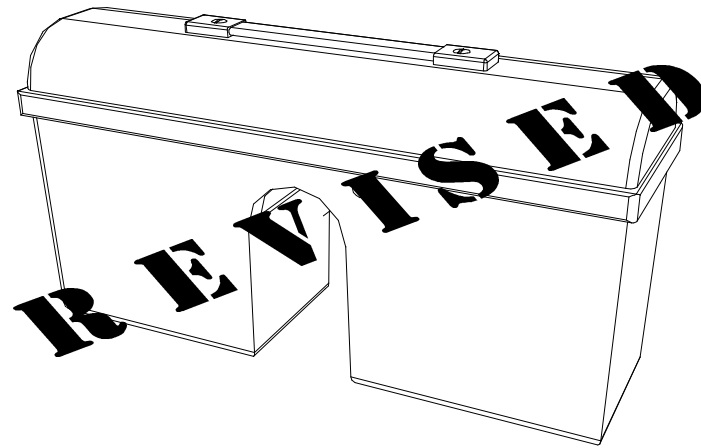

ELECTRIC  
TRANSPORTATION  
COMPANY



*ETC EXPRESSä*

*RACK INSTALLATION & OWNERS'  
MANUAL*



Thank you for purchasing the *ETC EXPRESS*. The *ETC EXPRESS* is complete with everything in one package: batteries, motor, control and charger. With your new *ETC EXPRESS* you'll be riding pollution-free and having fun too. The *ETC EXPRESS* is designed to fit virtually any style of bicycle. Use it to extend your rides, commute pollution free to work or school and because it's removable, ride as usual, anytime.

## CHARGING THE BATTERIES

**CHARGE THE BATTERIES OVERNIGHT BEFORE YOUR FIRST RIDE.** It couldn't be easier. Simply connect the socket end of the AC cord provided to the power connector above the nameplate on the front of your *ETC EXPRESS* power pack. Connect the plug end to any standard, grounded 120 VAC 60Hz wall outlet. Charging is automatic. **After a long ride keep your *ETC EXPRESS* power pack on charge overnight.** Your batteries will last longer if you keep them fully charged at all times. **FOR BEST RESULTS DO NOT RUN THE BATTERIES DOWN COMPLETELY. THIS WILL DAMAGE THE BATTERIES AND DRASTICALLY SHORTEN THEIR RECHARGE LIFE.**

## SAFETY FIRST

***ALWAYS WEAR A HELMET WHEN RIDING ANY BICYCLE.***

**Product Warning:** This *ETC EXPRESS* Power Pack is for use ONLY with the *ETC NEW CENTURY* , *ETC TRAVELER*  Folding Bicycle or with the *ETC EXPRESS* rack. To mount the *ETC EXPRESS* rack, please review the instructions for proper installation. Bicycling with the *ETC EXPRESS* power pack is, in most cases, as easy as normal riding, however, the added weight will make your bicycle feel top heavy. This different feel is because of the higher center of gravity created by the additional weight of the pack. Riders should, therefore, be aware the bike is more likely to tip from side to side, especially at slow speed or at a stop.

---

This product is not designed for off-road use, nor should it be used for such purpose. Although the product is designed to be adapted to a wide variety of bicycle styles, it may not fit all makes and models of bicycles.

**Keep your tires properly inflated for best performance and safety.**

Bicycle theft is a problem everywhere. Always lock your bicycle and lock the power pack into the rack or take your power pack with you whenever your bike is left unattended.

California law allows the use of the *ETC EXPRESS* for anyone over the age of 16 years without any special license. However, the laws vary from state to state. Before riding, please check with your local law enforcement office for any applicable laws in your area.

## OPERATION

To operate your *ETC EXPRESS*, simply start pedaling and when you are going approximately 5 MPH (8Km/Hr), depress & hold the trigger on the handle bar to engage power for as long as you want your *ETC EXPRESS* to help you ride. Release the trigger to coast, before you want to stop or anytime you want to turn the power off. Remember, you can use the bicycle brakes to stop or slow down at any time, just as always. **The *ETC EXPRESS* will not operate at speeds below 5 MPH (8Km/Hr).**

## GENERAL MAINTENANCE

Clean your *ETC EXPRESS* with a soft damp cloth. Dry completely. DO NOT immerse in water. If the drive wheel, which contacts the rear tire, becomes caked with road dirt, clean with a damp cloth to loosen the dirt, then dry completely.

# RACK ASSEMBLY

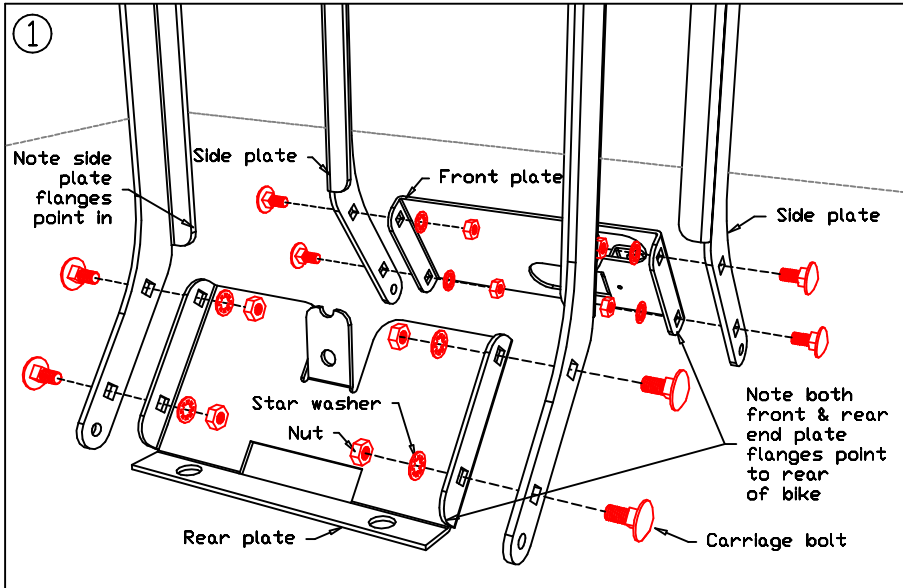

Assemble 2 side plates to the front & rear plates with the carriage bolts, star washers and nuts provided. Tighten nuts with rack frame upside-down on table top to insure proper alignment.

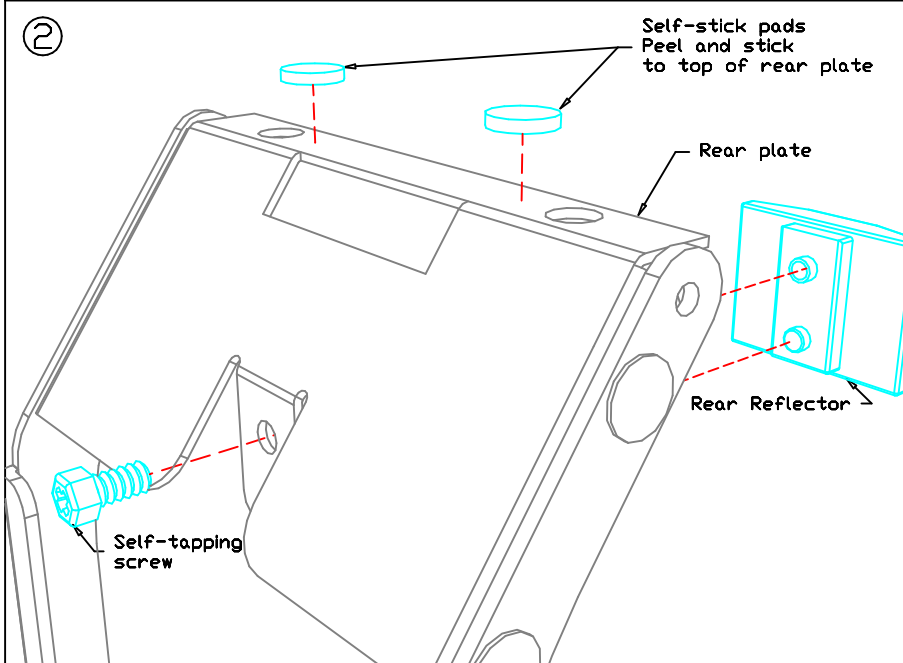

Attach the rear reflector to the rear plate of the rack with the self tapping screw provided.

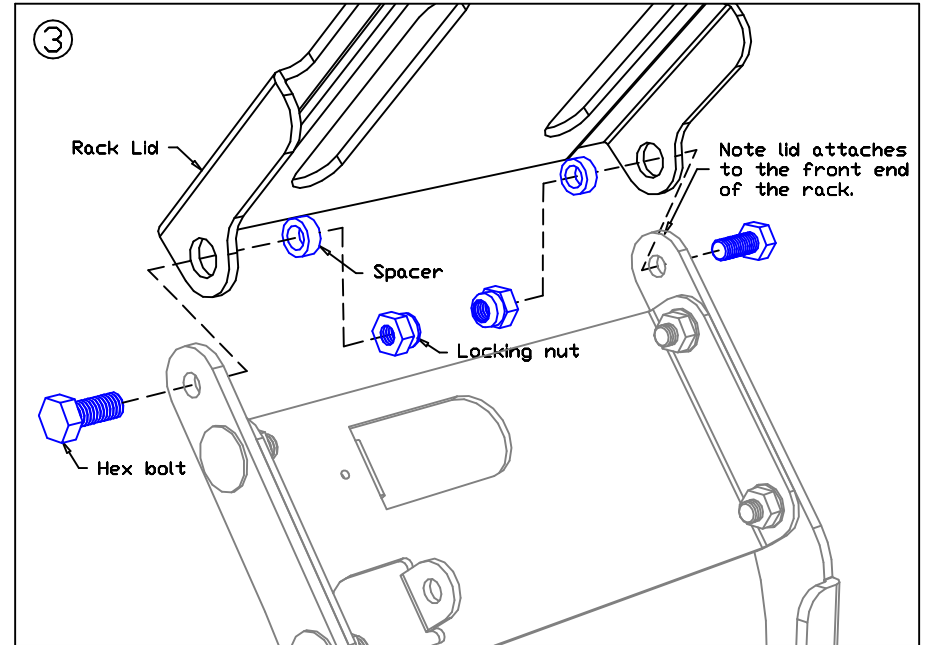

Install the rack lid on the front end of the rack with the hex bolts, spacers & locking nuts provided.

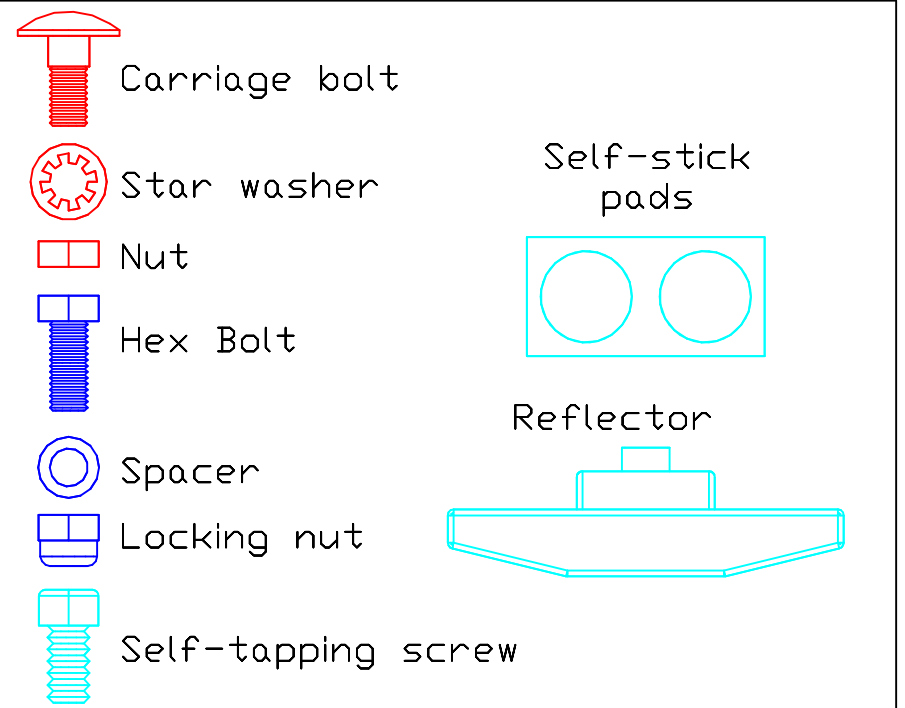

# Trigger & Cable Installation

Note: Remove Tie Wrap Holding Actuator

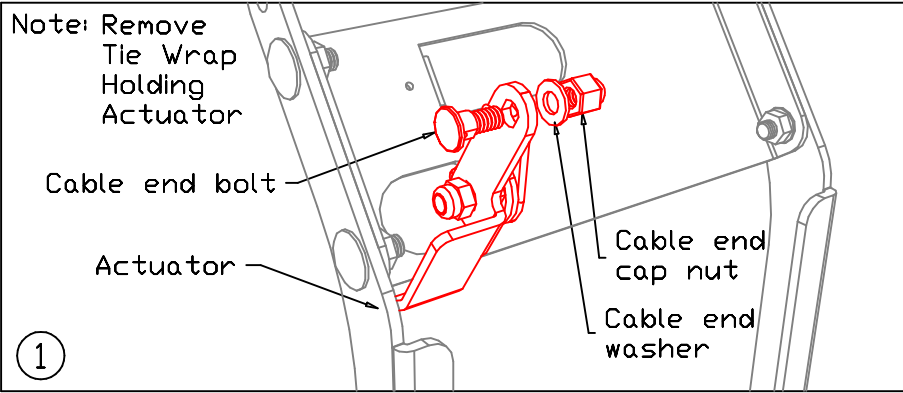

1

Install the cable end bolt, washer & nut.

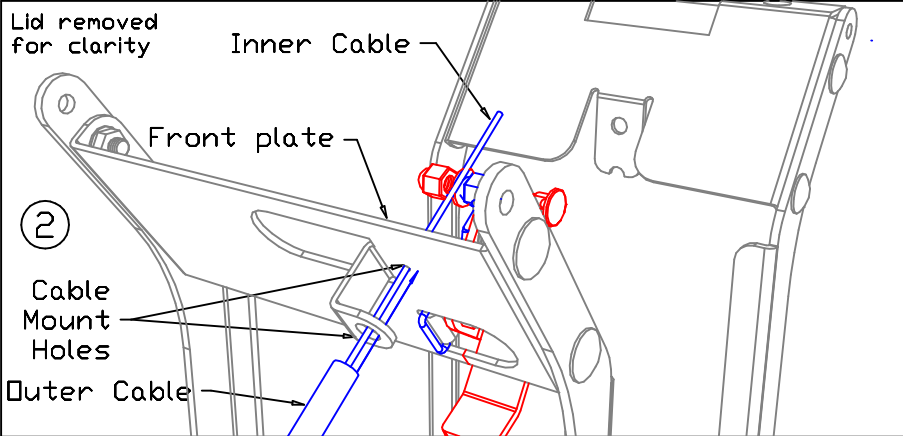

2

Feed the Inner cable end through the front plate cable mount holes until the outer cable is tight against the front plate.

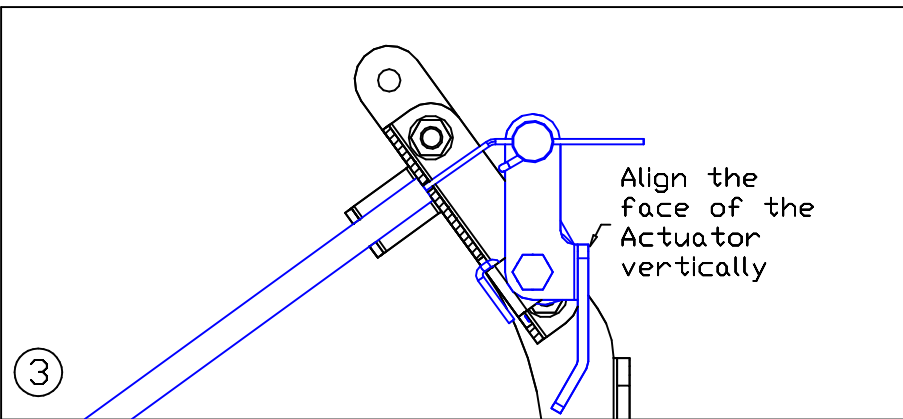

3

Feed the inner cable end through the cross hole in the cable end bolt. Adjust the Actuator until it is vertical and tighten the end bolt cap nut.

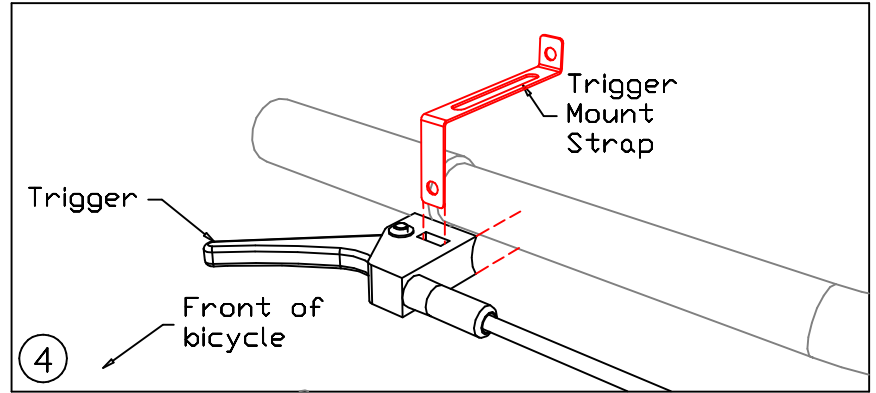

4

Install the Trigger on the right side of the handlebars (if possible) with the trigger lever on the front of the bar. Slide the Trigger mount strap through the square hole in the trigger.

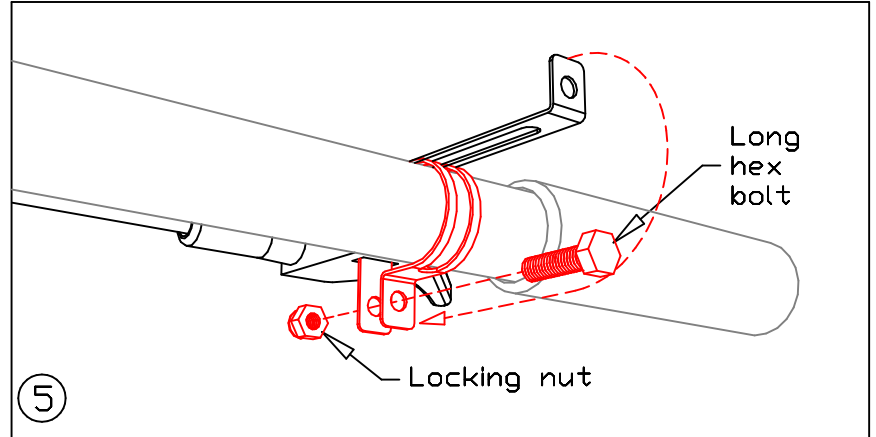

5

Bend the Trigger mount strap around the back of the bar and secure the Trigger to the handlebar with the Long hex bolt and Locking nut provided.

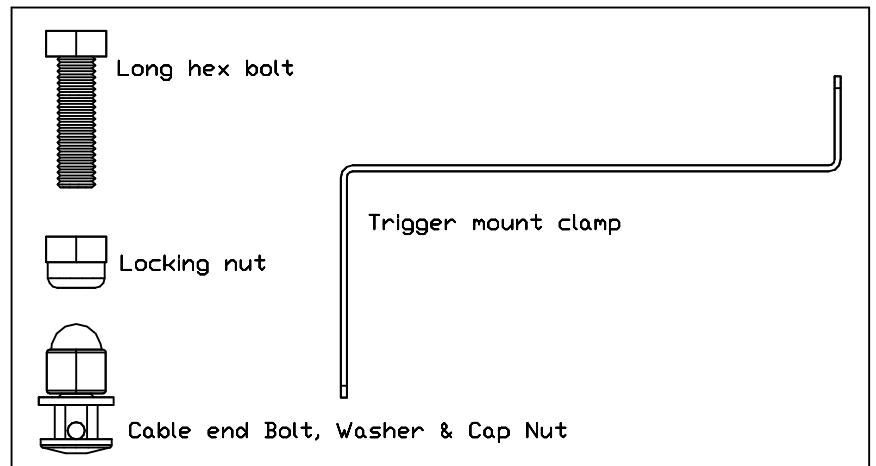

## Locating the Rack Using the Rack Alignment Gauge

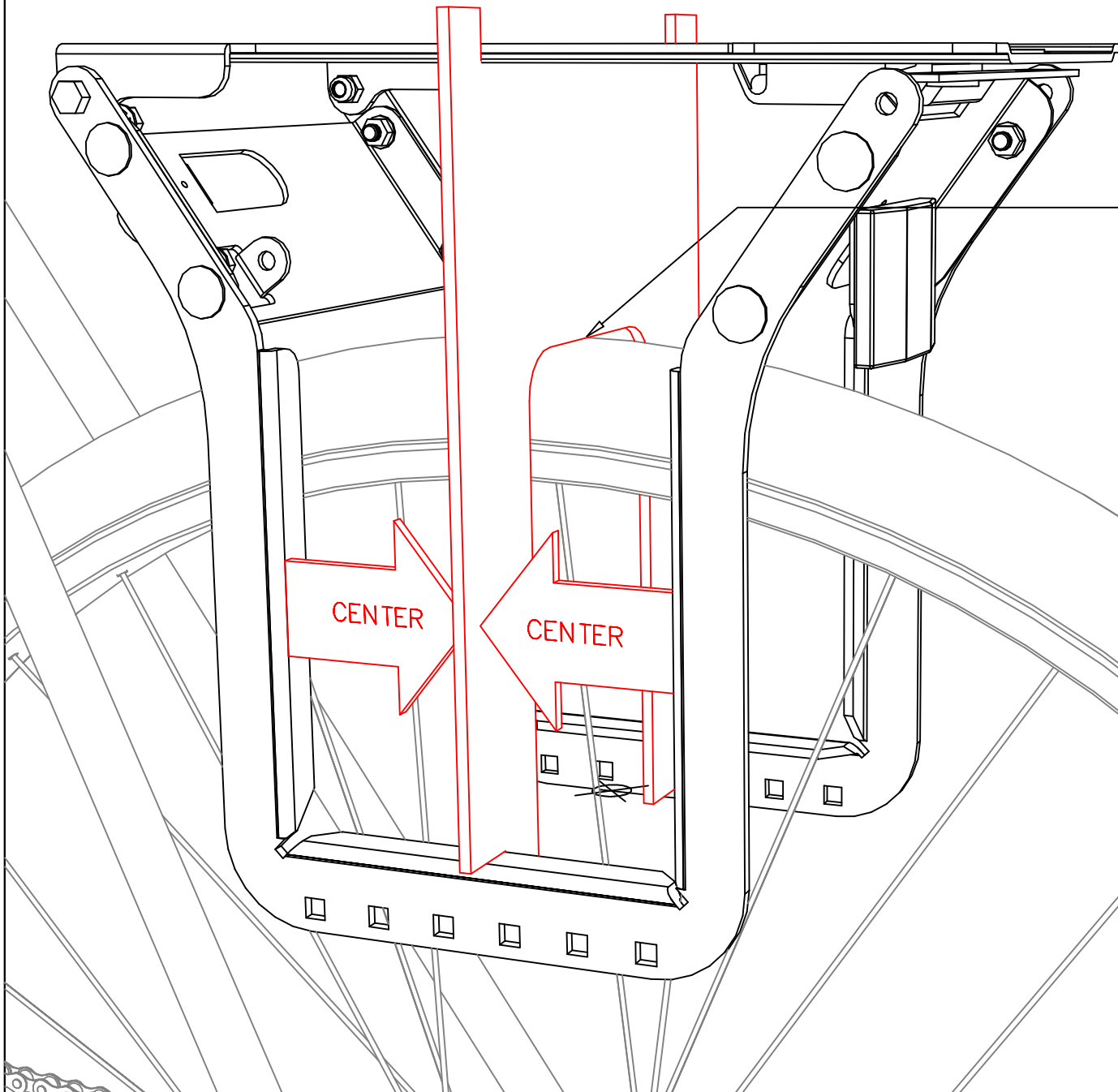

Align rack over the rear tire so that the Gauge contacts the tire with Gauge centered in the rack left to right & front to back as shown.

See Instructions included with specific bicycle mounting adapter for attaching the rack to the bicycle frame.

NOTE: Depending on bicycle frame configuration, the Gauge may contact the tire either in front or behind the top center of the tire.

# ETC Express Installation

①

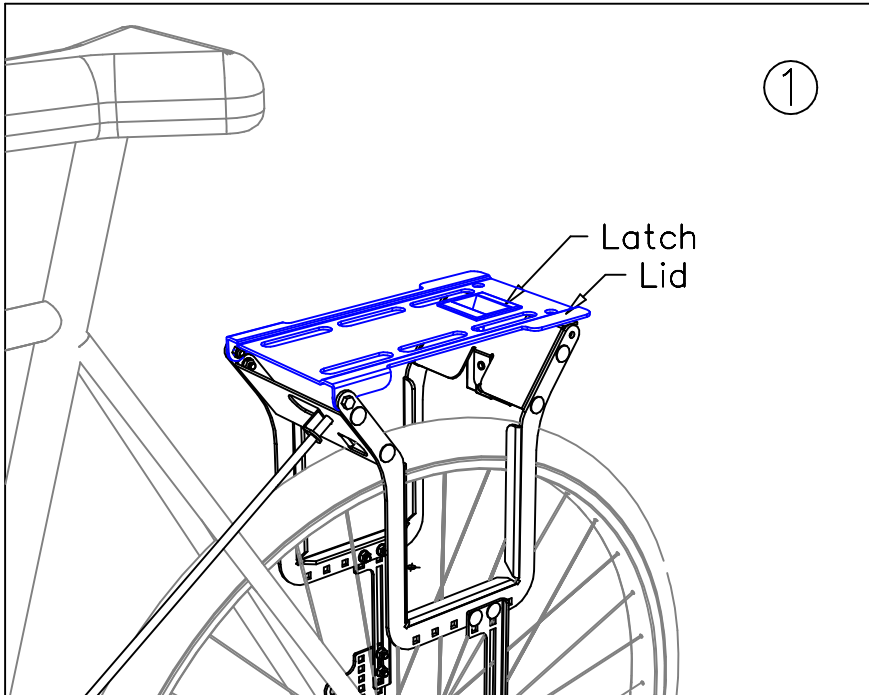

Slide Latch forward, Lift Lid.

③

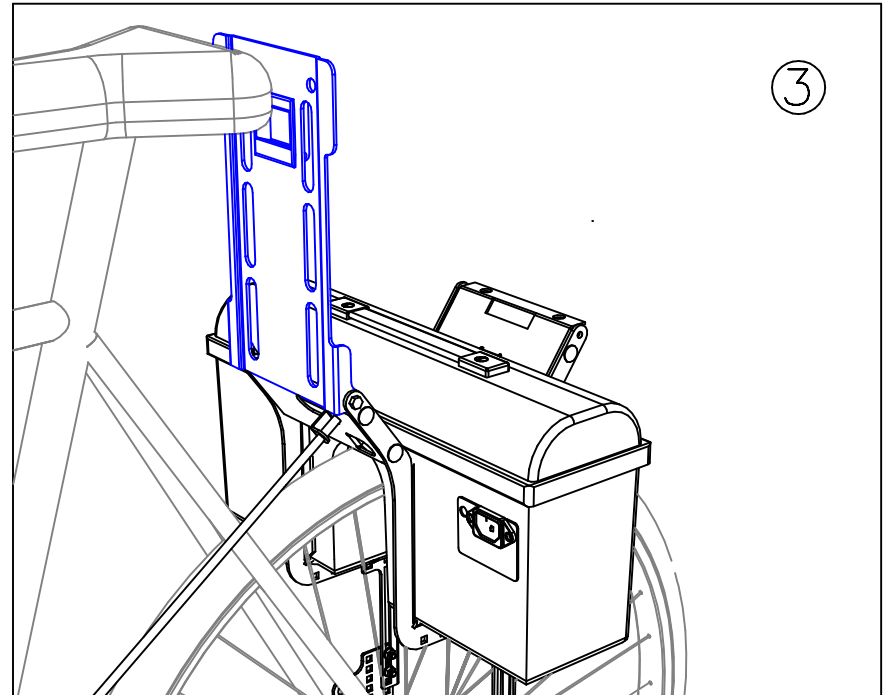

Be sure Express Pack is fully seated in rack

②

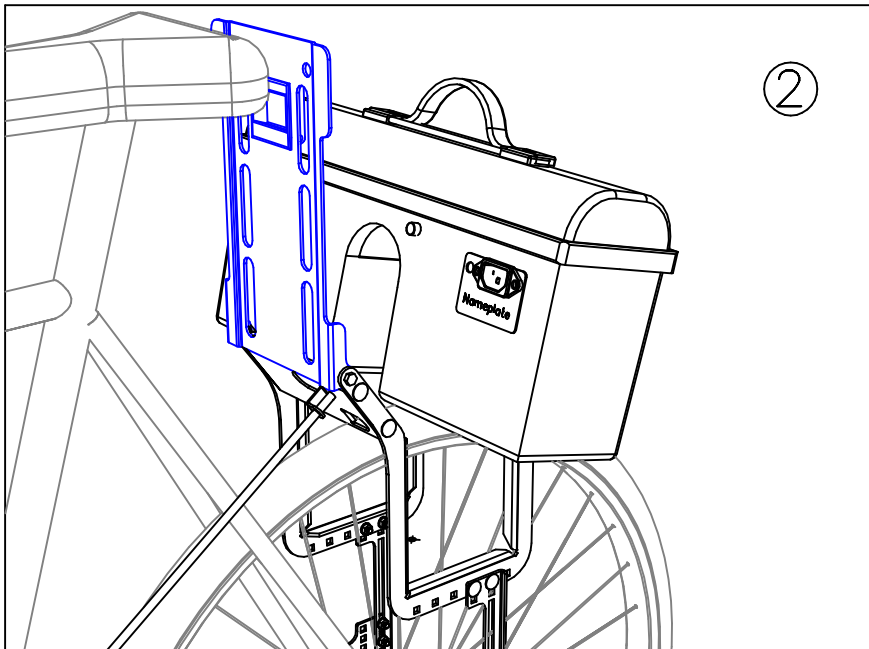

With Nameplate forward, Slip Express Pack into Rack.

④

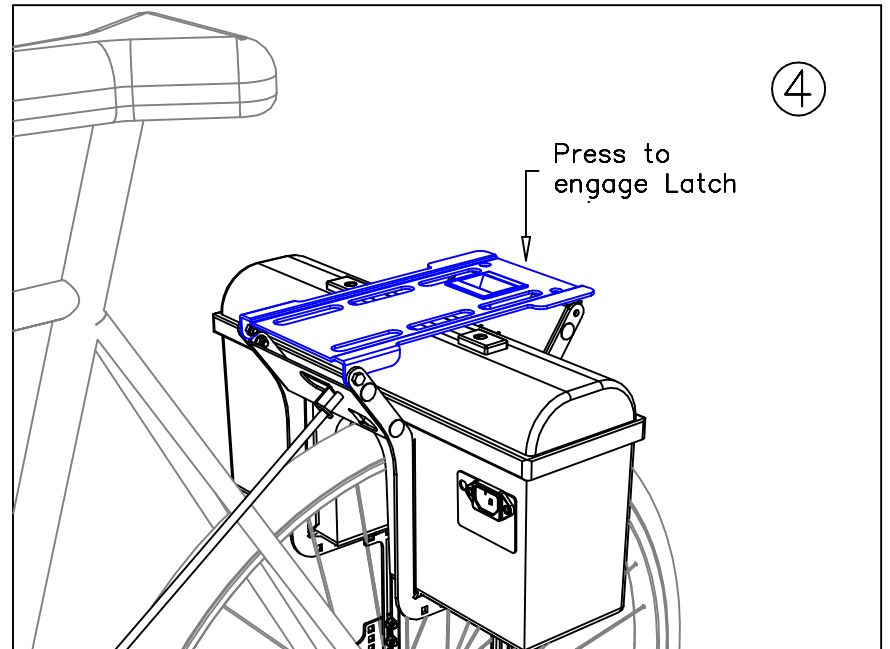

Lower Lid, press on back end of lid to engage Latch

## WARRANTY

**1. What is covered by this warranty:** Electric Transportation Company, LLC (“ETC”) warrants, to the original purchaser only, that the ETC Express™, that is the subject of this sale conforms to ETC’s published specifications and is free from defects in material or workmanship. This warranty expires one year from the date of delivery. If the buyer discovers within this period a failure of the product to conform to specifications, or a defect in material or workmanship, the buyer must promptly notify ETC in writing. In no event may that notification be received by ETC later than 13 months from the date of delivery. Within a reasonable time after notification, ETC will correct any failure of the product to conform to specifications or any defect in material or workmanship, with either new or used replacement parts. Such repair, including both parts and labor, will be performed at ETC’s expense. All warranty service will be performed at a location designated by ETC. If ETC is unable to repair the product to conform to the warranty after a reasonable number of attempts, ETC will provide, at it’s option, one of the following: a replacement product or a full refund of the purchase price. These remedies are the purchaser’s only remedies for breach of warranty.

**2. What is not covered by this warranty:** ETC does not warrant (a) the battery component of the product for more than 90 days; (b) damage caused by use of the product for purposes other than those for which it was designed; (c ) damage caused by disasters such as fire, flood, wind, lightening, theft, or other matters not within ETC’s control; (d) damage caused by unauthorized attachments or modifications; (e) damage caused during shipment; (f) any other abuse or misuse by the purchaser; or (g) the use of this product without the ETC Express rack, the ETC NEW CENTURY or the ETC TRAVELER.

**3. Limitation of remedies; disclaimer of warranty:** In no event will ETC be liable for any special, incidental, or consequential damages based on breach of warranty, breach of contract, negligence, strict tort, or any other legal theory. Damages that ETC will not be responsible for include, but are not limited to, loss of profits; loss of savings or revenue; loss of use of the product or any associated equipment, facilities, or services; downtime; the claims of third parties including customers; and injury to property. This limitation does not apply to damages caused by breach of the warranty of title and against infringements or to claims for personal injury.

**4. Time limit:** Any action for breach of warranty must be commenced within 15 months following delivery of the product.

**5. No other warranties:** Unless modified in a writing signed by both parties, this agreement is understood to be the complete and exclusive agreement between the parties, superseding all oral or written prior agreements and all other communications between the parties relating to the subject matter of this agreement, including statements made by salespersons. No employee of ETC or any other party is authorized to make any warranty in addition to those made in this agreement. The buyer is warned, therefore, to check this agreement carefully to see that it correctly reflects those terms that are important to the buyer.

**6. Allocation of risks:** This agreement allocates the risks of product failure between ETC and the buyer. This allocation is recognized by both parties and is reflected in the price of the goods. The buyer acknowledges that it has read this agreement, understands it, and is bound by its terms.

**THE FOREGOING WARRANTIES ARE IN LIEU OF ALL OTHER WARRANTIES, EXPRESS OR IMPLIED, INCLUDING BUT NOT LIMITED TO THE IMPLIED WARRANTIES OF MERCHANTABILITY AND FITNESS FOR A PARTICULAR PURPOSE.**

## SPECIFICATIONS

### *ETC Express<sup>™</sup>* Parts List

Part Number	Quantity	Description
ETCEXP02A-P	1	Power Pack
ETCEXP02A-T	1	Charging Transformer
ETCRAC4M1-A	2	Side Plate
ETCRAC4M1-B	1	Lid with Latch
ETCRAC4M1-C	1	Front Plate with Actuator
ETCRAC4M1-D	1	Rear Plate
ETCRAC4M1-E	1	Rear Reflector
ETCRAC4M1-F	8	Carriage Bolt
ETCRAC4M1-G	8	Star Washer
ETCRAC4M1-H	8	Nut
ETCRAC4M1-I	2	Hex Bolt
ETCRAC4M1-J	2	Spacer
ETCRAC4M1-K	3	Locking Nut
ETCRAC4M1-L	1	Self-tapping Screw
ETCRAC4M1-M	2	Self-stick Pads
ETCRAC4M1-N	1	Trigger w/Cable
ETCRAC4M1-O	1	Trigger Mount Strap
ETCRAC4M1-P	1	Cable End Clamp
ETCRAC4M1-Q	3	Cable Tie Wraps
ETCRAC4M1-R	1	Long Hex Bolt
ETCRAC4M1-S	1	Rack Alignment Gauge

Tools required: 2 - 8mm wrenches

Type:	Fully Removable Electric Power Pack with Built-in Motor, Control, Charger and Batteries
Weight:	27 Lbs. (12.25 Kg)
Dimensions:	16" (406 mm) Long x 4 3/4" (120 mm) Wide x 7 3/4" (200 mm) Height
Drive:	Friction on rear tire
Batteries:	Dual 12 volt, 12 amp sealed gel-cel lead acid
Electronic Control:	Current response power manager to optimize performance and battery life
Minimum Speed:	5 MPH (8 Km/Hr)
Maximum Speed:	16 MPH (26 Km/Hr)
Charger:	120 VAC 60 Hz @ 1 Amp Built-in self-regulating to prevent over charging
Full Recharge:	6 to 8 hours
Trigger:	Handlebar-mounted on/off control operating at speeds above 5 MPH (8 Km/Hr)
Operating Temperature:	40°F (4.5°C) to 100°F (38°C)



ELECTRIC

TRANSPORTATION

COMPANY

*ETC EXPRESS<sup>ä</sup>, ETC TRAVELER<sup>ä</sup>, ETC NEW CENTURY<sup>Ö</sup> & THE ETC LOGO ARE TRADEMARKS OF*

THE ELECTRIC TRANSPORTATION COMPANY, LLC. *PATENTS PENDING*  
 COPYRIGHT © 1998 THE ELECTRIC TRANSPORTATION COMPANY, LLC.

THE ELECTRIC TRANSPORTATION COMPANY, LLC.  
 1486 EAST VALLEY ROAD • SANTA BARBARA, CA 93108  
 (888) 808-4ETC • www.etcbikes.com

The information in this manual is correct to the best of our knowledge.  
 It is subject to change without notice.